

HOW TO USE

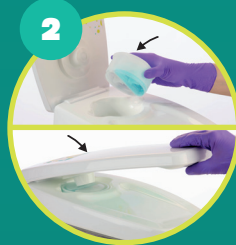

Fill TANK with ambient tap water until it reaches the 5L mark. Do not use hot water.



Take one TANK ClO₂ capsule and place it into the TANK lid with the laminate seal facing down. Close the lid to burst the capsule.



Open the lid and remove the now empty capsule. This can be rinsed out and sent for recycling.



Fill TANK with additional ambient tap water until it reaches the 10L mark.



The TANK ClO₂ will need 15 minutes to dwell, before it is ready to use.



Grab a bottle, flip the tap to open, and fill with working solution. The reusable 500ml bottles can be paired with any of the available applicators.



Your working solution can be kept for up to 5 days within TANK or 24 hours in a 500ml bottle. To keep track of this, make a note of the time and date on the TANK lid and any bottles you decant the solution into.



Apply the working solution onto a wipe, or directly onto a surface, and wipe.



Ensure the surface remains wet for 5 minutes. Apply additional solution as needed. Leave to dry.

PRE-USE CHECKS

Some important reminders before starting:

- Use biocides safely. Always read the label and product information before use.
- Wear the appropriate personal protective equipment (PPE).
- TANK ClO₂ is for professional use only.
- Do not apply TANK ClO₂ to brass, copper, aluminium, mild steel, or silver surfaces.
- Ensure surfaces are free from heavy soiling before use.
- Before preparing your solution, make sure your TANK is empty. It should be located on a flat surface, close to a water source in a central location. Remember to check the tap is closed before filling!

REFILLING YOUR TANK

Before refilling TANK ensure any remaining solution is disposed of in accordance with local regulations. To clean TANK, wipe down all surfaces with a dry, low-linting cloth. Do not immerse TANK in water.

STORAGE CONDITIONS

TANK ClO₂ capsules have a 2 year shelf life, and should be stored in a cool dry place, out of direct sunlight, between 10°C - 35°C.



Refer to the User Guide for full instructions.